

**Product Features**

P1CO-SAF4-E059P012 is a 50 Ohm RF connector. It's an SMA Female 4-hole flange mount design with an extended dielectric and .012 inch center contact. Passivated stainless steel body with epoxy captivated center contact.



**Electrical Specification:** T<sub>Ambient</sub> = 25° C

Parameter	Frequency Range	Units	Min	Typical	Max	Notes
Impedance				50.0		

**Mechanical And Environmental Specifications:**

Parameter	Description	Notes
RoHS Compliance	Yes	

**Drawing**

EPOXY CAPTIVATION

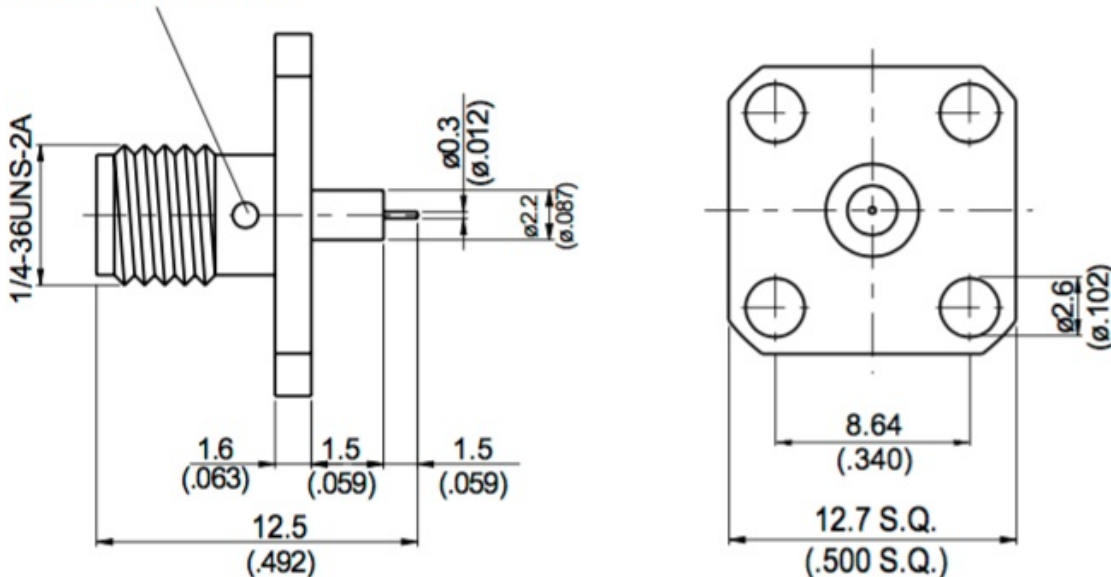

**Graph**

Parts	Material	Plating (Micro-inch)
Contact Pin	Beryllium Copper	Gold 20 Over Nickel 50 Over Copper 50
Insulator	Teflon	
Body	Stainless	Passivated

**Product Notes**