

P1PD-29F-DC40G1W-2

Power Divider, Resistive, DC to 40 GHz, 2-Way, 1 Watt, 2.92mm female connectors.
Case measures 0.6 x 0.6 x 0.4 inch.

Product Features

P1dB's ultra-broadband DC to 40GHz Power Splitter is a 3-port device with 2.92mm female connectors. Power division between any input and either output. Insertion Loss, Input port measured to either Output port, is 6dB typical. This broadband 2-way divider operates from DC up to 40 GHz. Power handling is 1 Watt CW. Amplitude stability is 0.3 dB max DC -40 GHz.

Temperature range is -55 to +125 degrees C.

Housing dimensions: 0.6 x 0.6 x 0.4 inches. Mounting holes 0.4 inch center-to-center.



Electrical Specification: $T_{\text{Ambient}} = 25^{\circ}\text{C}$

Parameter	Frequency Range	Units	Min	Typical	Max	Notes
Frequency Range		GHz	DC		40.0	

Mechanical And Environmental Specifications:

Parameter	Description	Notes
RoHS Compliance	Yes	

Drawing

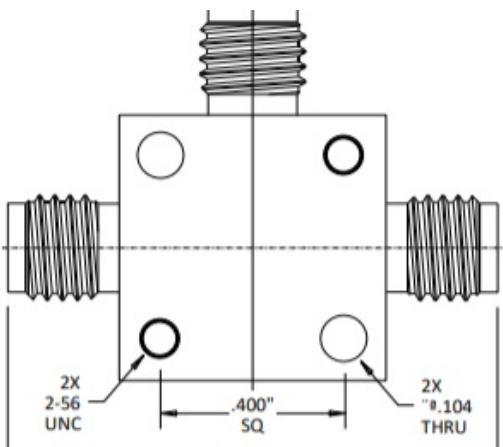

P1PD-29F-DC40G1W-2

Power Divider, Resistive, DC to 40 GHz, 2-Way, 1 Watt, 2.92mm female connectors.
Case measures 0.6 x 0.6 x 0.4 inch.

Graph

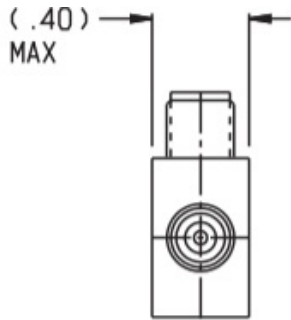

Product Notes